

RAMMER EC60 EXTENSION CARRIAGE



EASILY INSTALLED ON VARIOUS CARRIERS

Recommended carrier: Sandvik LH307 or equivalent

GREAT FLEXIBILITY AND EQUIPMENT UTILIZATION

One unit and an operator can efficiently work at several applications, allowing a quick use of the carriage where needed

HEAT TREATED CONICAL PINS

The pins have an increased service life and can easily be removed when replacing the bushings

DESIGNED FOR HEAVY DUTY APPLICATIONS

Heavy duty structures and cylinders

THE SAME LOADER FOR BREAKING AND LOADING

The feeder is typically installed with a bracket having the same mounting pattern with the bucket.

SPECIAL BRONZE BUSHINGS WITH GREASE DEPOTS

IDEAL FOR CLEARING DRAW POINT BLOCKAGES

Operator is protected, either in the loader or within remote control, making the clearing safe and efficient

EC EXTENSION CARRIAGES

Extension carriages are specially designed for clearing draw point blockages. Draw point blockage always presents a risk, and with this mobile breaker system the clearing can be done safely and efficiently. Extension carriages are also ideal for various mobile underground grizzly applications. One unit and an operator can efficiently work at several grizzlies, which improves flexibility and equipment utilization.

**Ram
mer®**

EC60

SPECIFICATIONS

Weight, kg (lb)	1,450 (3,200)
Feed stroke, mm (in)	600 (23.6)
Frame structure	Welded steel plate construction
Cylinder type	Double acting cylinder with self aligning bearings
Max. pressure	25.0 MPa
Dimensions Piston/Rod-Stroke	100/56-650 mm
Control valve	1 on/off section for feed movement 1 on/off section for hammer function

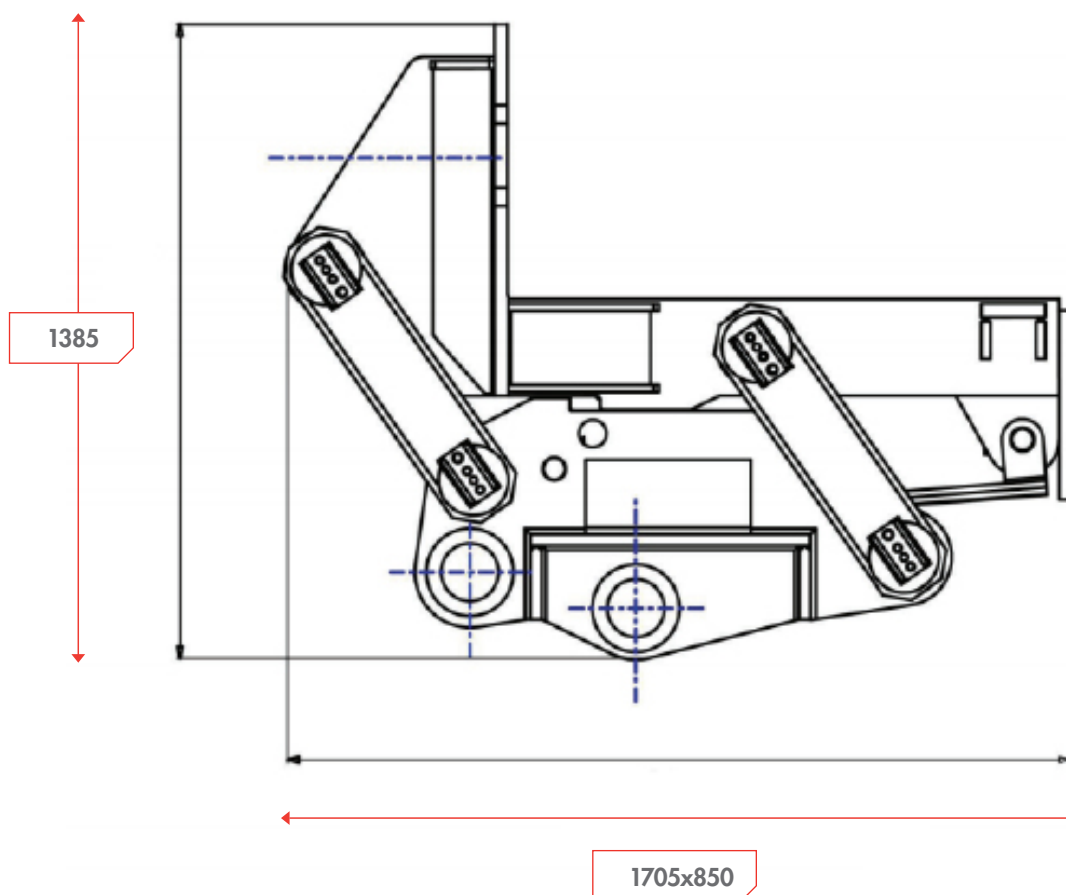

Sandvik Mining and Construction Oy
Taivalkatu 8, P.O.Box 165
FI- 15101 Lahti, Finland
Phone Int. +358 205 44 151
www.rammer.com

 **Walkers Hammers**
HYDRAULIC ATTACHMENT SPECIALIST

**Ram
mer®**